



# MYTA INDUSTRIAL

At the Service of the Industry  
Technical Office Department

- Automation
- Process control
- Robotic cells
- Verification tooling
- Development and integration of production lines
- Special machines
- Cartesian robots for stacking
- Project management and Execution
- Machining



**We can build your ideas, we can create what you need.**



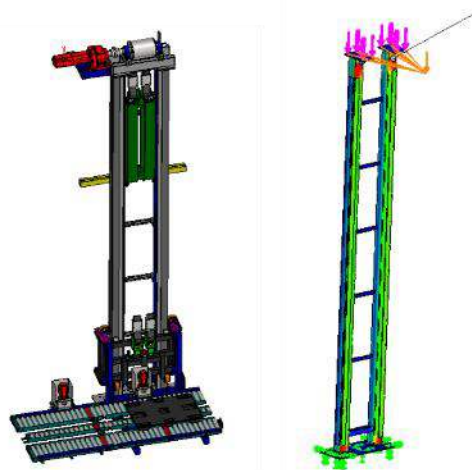

## LIFTERS AND CONVEYORS FOR PALLETS

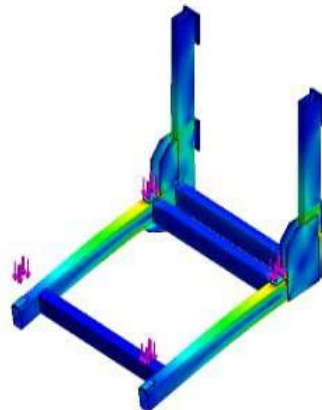
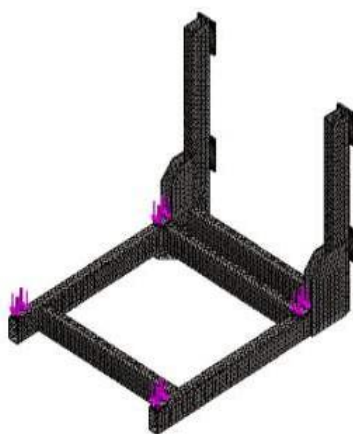
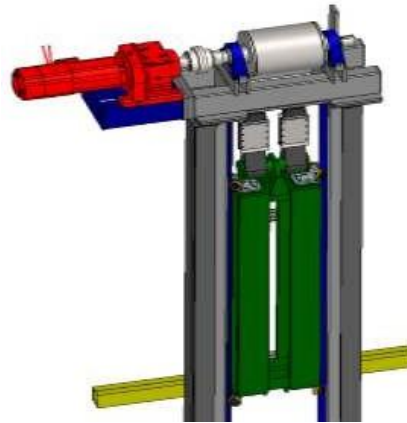
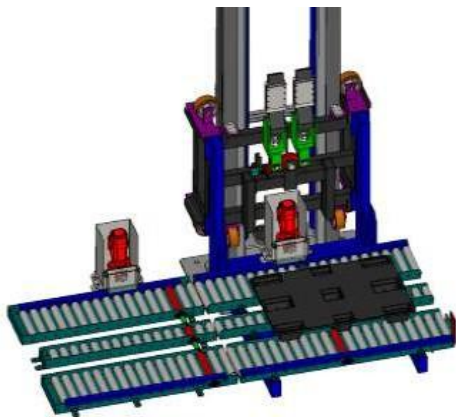

von Mises ( $\sqrt{3}$ ) (MPa)

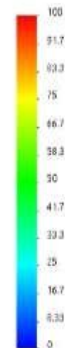

- Installation for the automatic transportation of pallets with meat products.
- The development, assembly, and full programming are entirely carried out by Myta Industrial.



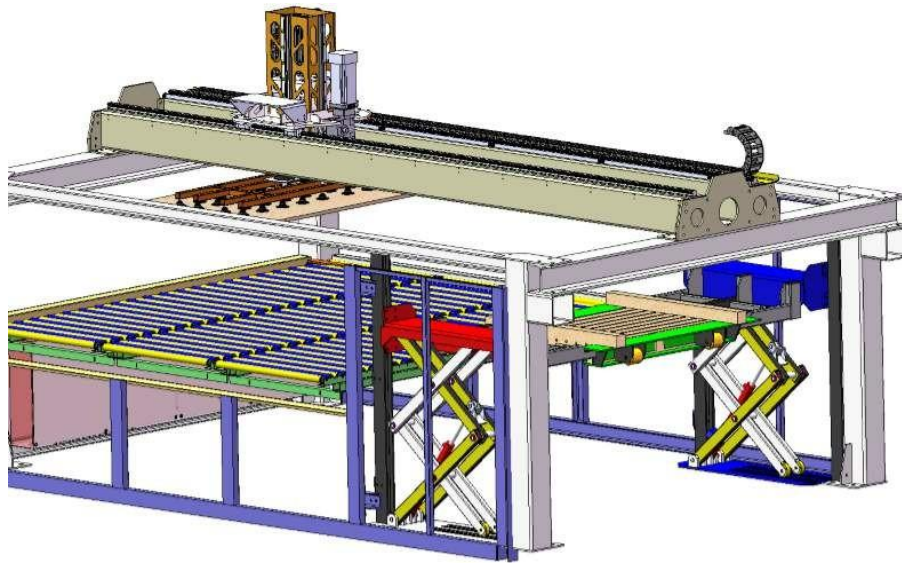

## STACKER FOR KITCHEN FURNITURE PANELS

- Machine for stacking kitchen cabinet panels.
- Integrated into a production line with automatic cutting and edging, this machine stacks panels according to production orders, taking into account the panel dimensions and the configuration of the previous shape.
- It includes a three-axis Cartesian robot and a hydraulic stacker with a load capacity of 1.5 meters and 1,000 kg.
- Development, assembly, and programming are fully implemented by Myta Industrial.

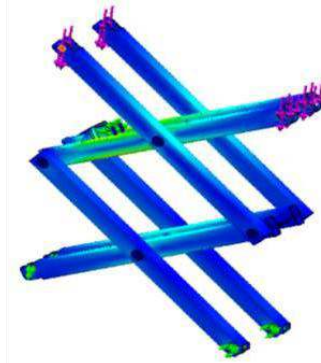
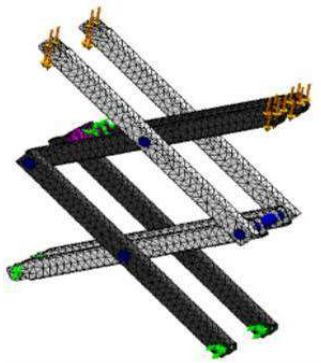

# MACHINE FOR SHAPING AND COOLING RUBBER TUBES

- Manufactured for Shaping Rubber Tubes
- This machine consists of three workstations: a heating oven, a cooling tunnel, and a loading and unloading area for the product.
- The development, assembly, and complete programming are carried out by Myta Industrial.

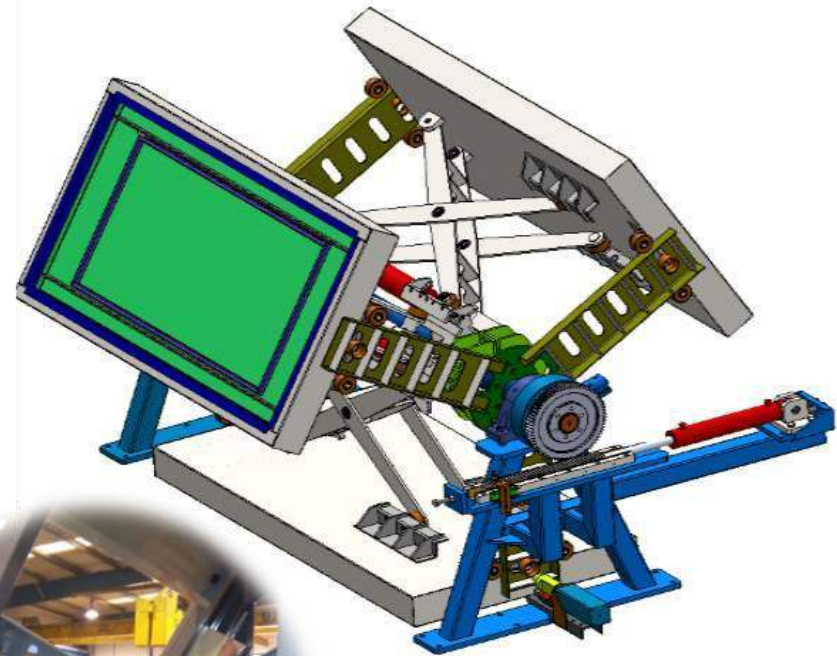
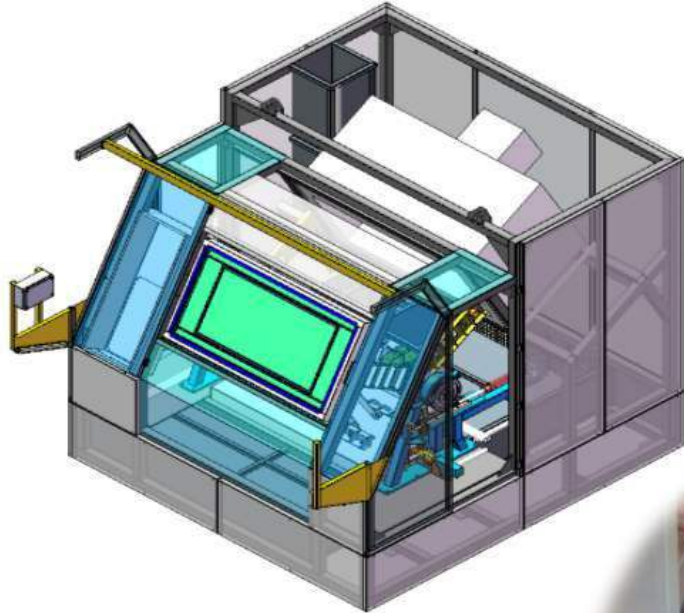

# SEMI-AUTOMATIC INDUSTRIAL WORKSTATION FOR INSERTION OF AUTOMOTIVE COMPONENTS

- The development, assembly, and complete programming are carried out by Myta Industrial.





# TRANSPORT LINE FOR OFFAL IN INDUSTRIAL SLAUGHTERHOUS

- Offal Transport Line
- Automated installation for the control, transport, and lubrication of the product, featuring a self-cleaning system during the process and after production.
- Development, assembly, and complete programming carried out by Myta Industrial.

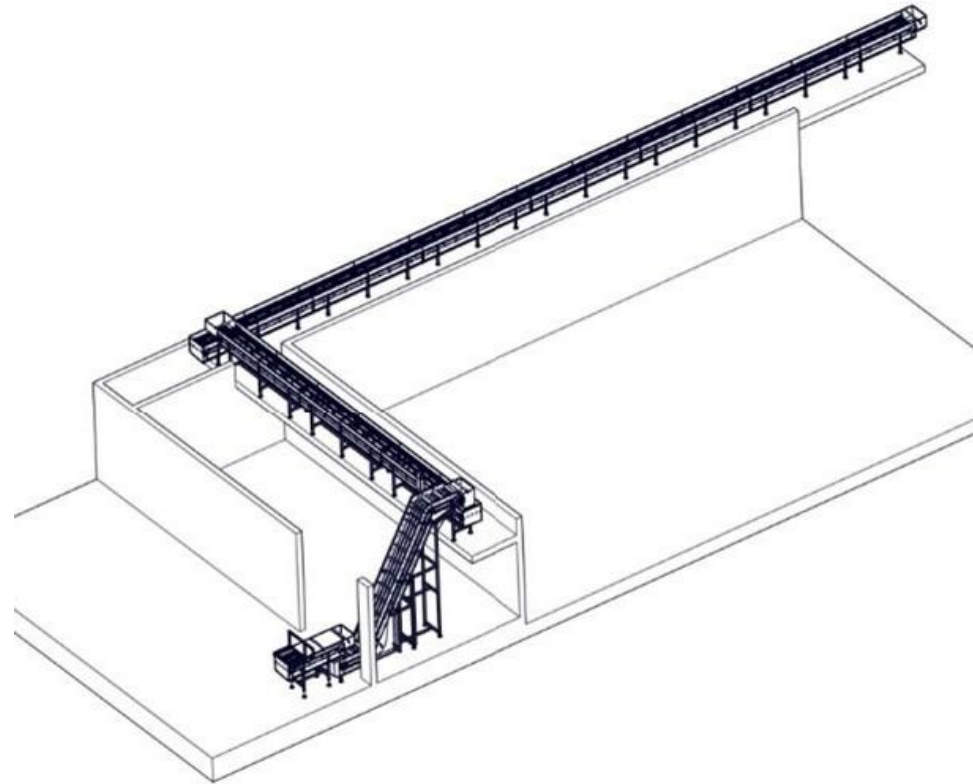
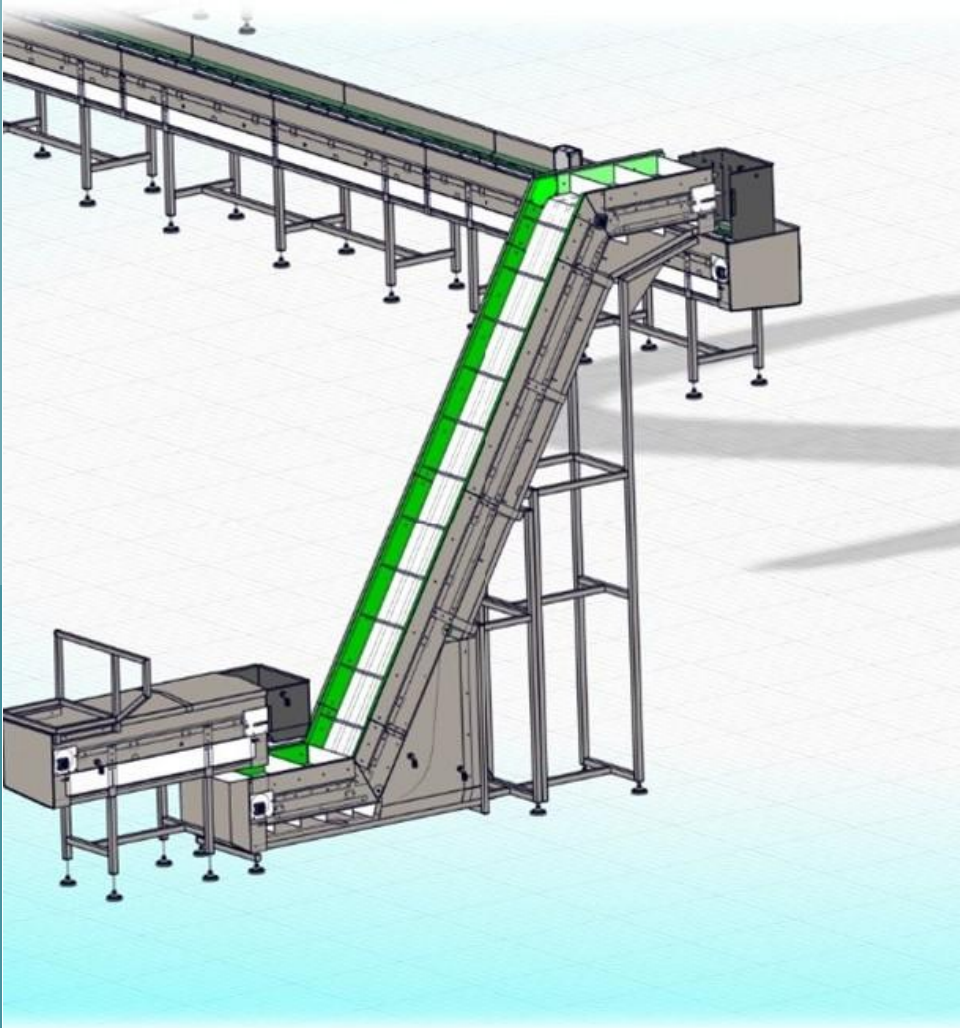

# AUTOMATIC LINE FOR ASSEMBLY AND PALLETIZING OF BATHROOM FURNITURE

- Line Composed of Machine Sets for Assembly and Packaging of Bathroom Furniture.
- The line is designed for the assembly of components and packaging of bathroom furniture, followed by stacking and storage. The installation includes machines for strapping boxes with laser-controlled strapping stops.
- A palletizing area equipped with a Fanuc robot.
- An automatic pallet unloading machine that feeds the pallets into the palletizing line.
- Automated roller conveyors for loading empty pallets, and once the boxes are stacked, they are transported to the warehouse.
- Line management and control via product recipes.
- Capable of simultaneous operation of two assembly lines.
- Development, assembly, and complete programming carried out by Myta Industrial.

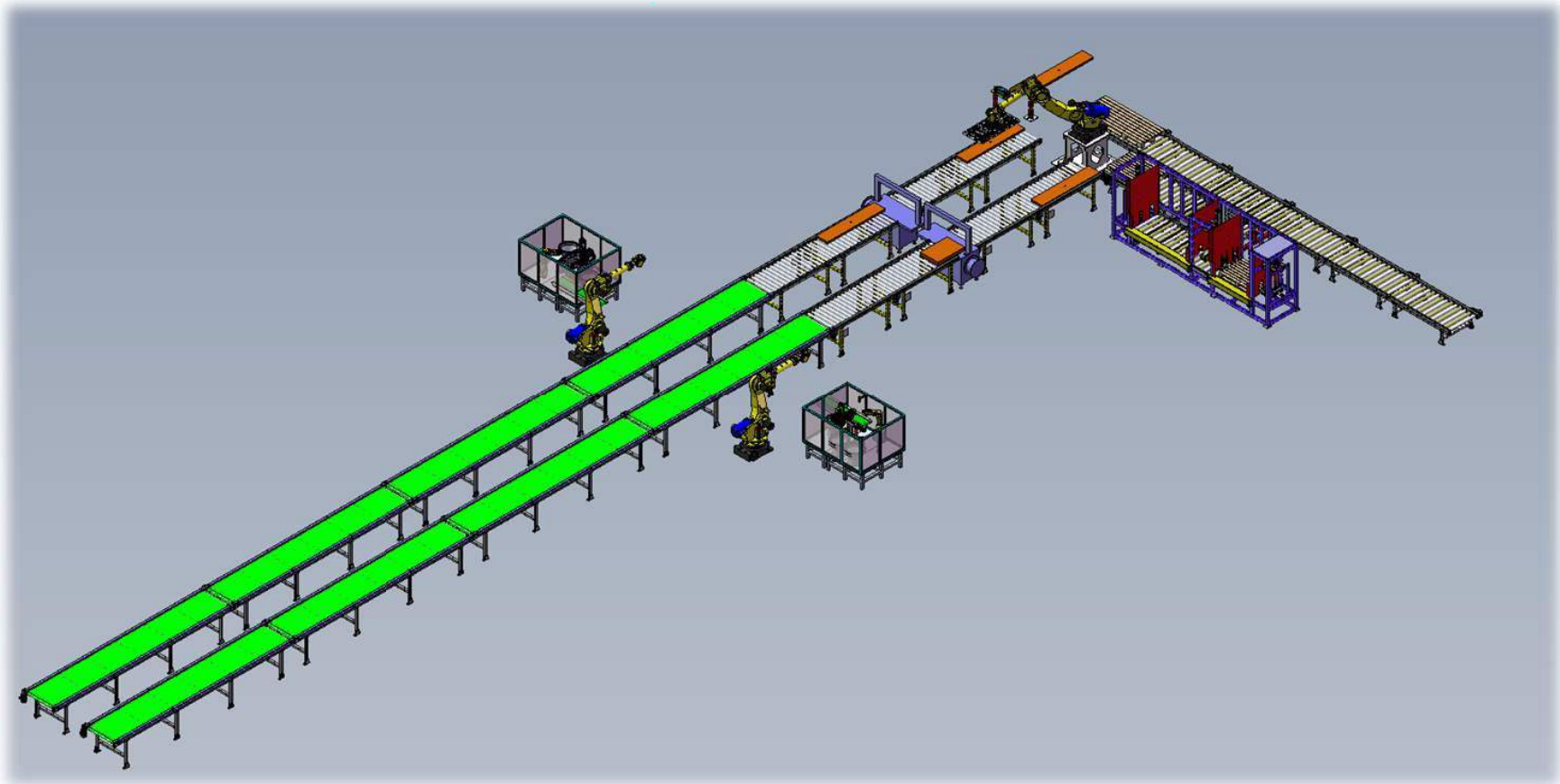





## INSTALLATION FOR DOSING PRODUCTS IN CANNING FACTORIES

- The development, assembly, and complete programming are carried out by Myta Industrial.

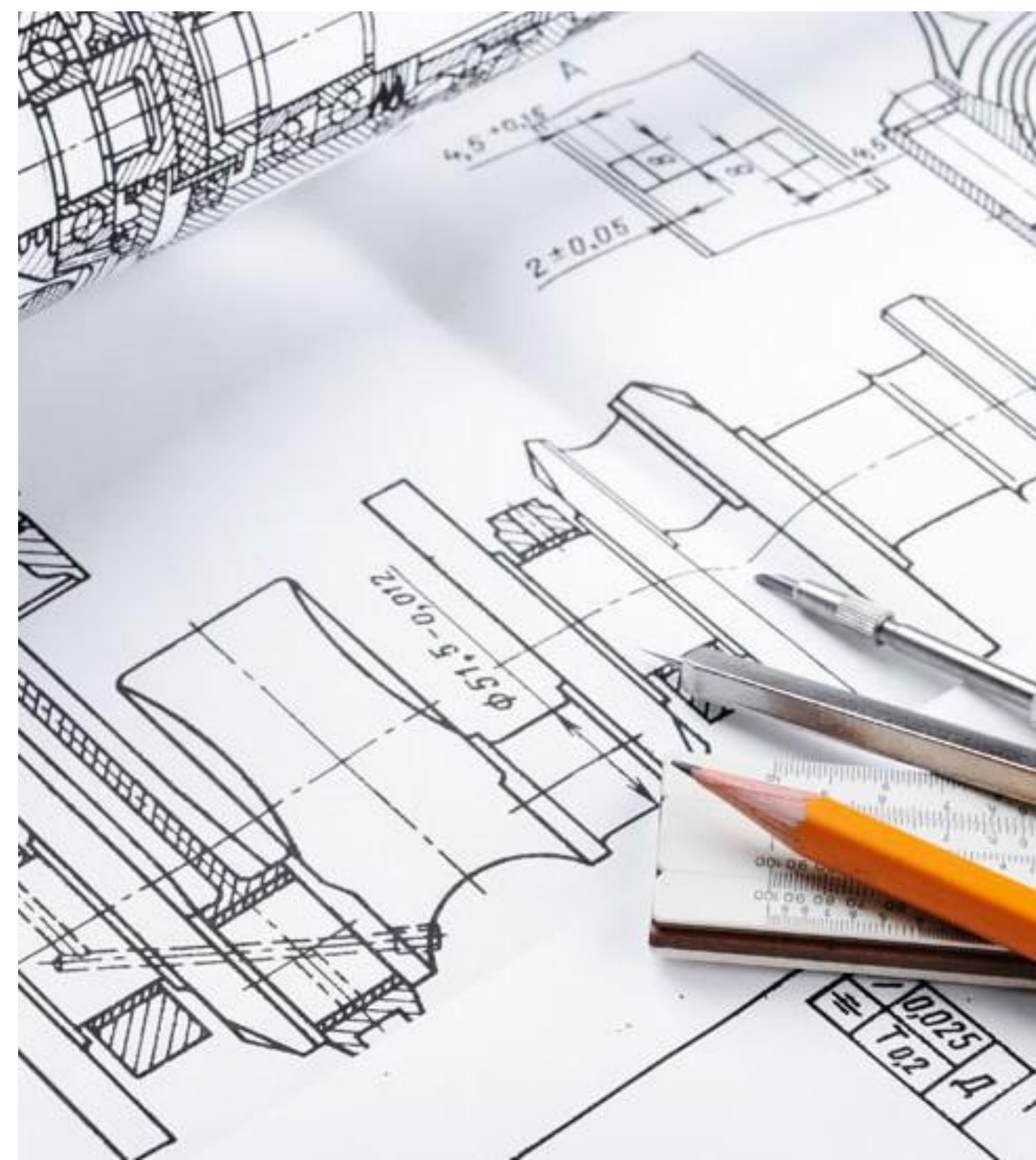

THANK YOU

AUTOMATION

[WWW.MYTAINDUSTRIAL.COM](http://WWW.MYTAINDUSTRIAL.COM)